

viking yachts

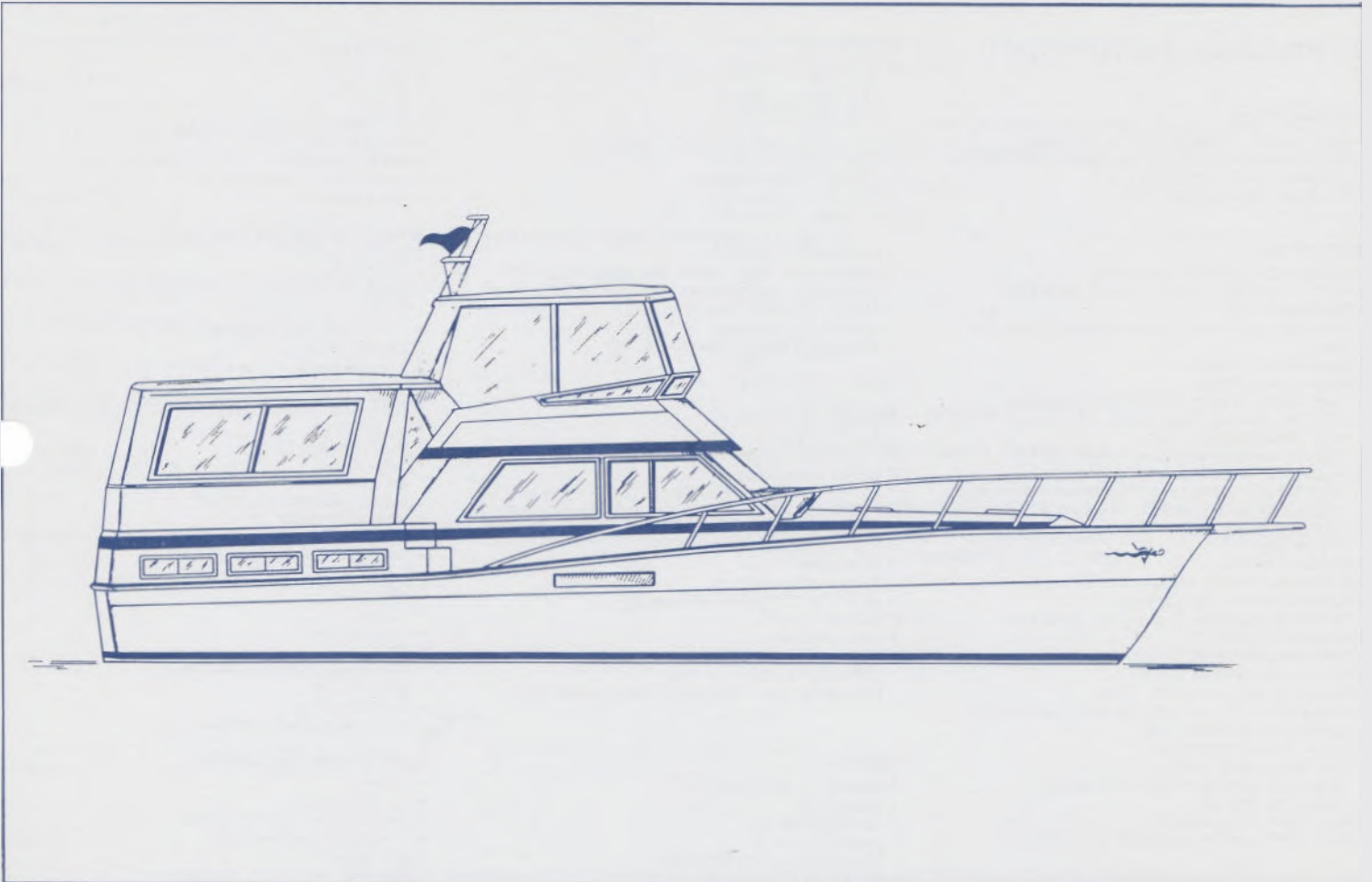

EFFECTIVE ON DELIVERIES
JANUARY 1, '87 THRU JULY 31, '87
PRICES SUBJECT TO CHANGE
WITHOUT NOTICE

viking 48' motor yacht specifications

48' MOTOR YACHT SPECIFICATIONS('

Length, overall (L.O.A.)	48'7"	14.81 meters.....	Height, waterline to top of flybridge windshield	12'5"	3.78 meters
Length, overall (including Bow Pulpit)	52'7"	16.03 meters.....	Height, bottom of cradle to top of pilothouse	12'10"	3.91 meters
Waterline length (LOMA	44'4"	13.51 meters.....	Height, bottom of cradle to top of flybridge windshield	15'11"	4.85 meters
Beam	1 6'0"	4.87 meters.....	Deadrise (Transom)	15.5°	15.5°
Draft	4'7"	1.37 meters	Gross Weight	•48,500 pounds	22,000.00 kilos
Freeboard, forward	5'9"	1.75 meters	Fuel Capacity	645 gallons	2,441.00 liters
Freeboard, aft	5'4"	1.63 meters	Water Capacity	200 gallons	757.00 liters
Height, waterline to top of pilothouse	9'4"	2.84 meters.....			

STANDARD EQUIPMENT

CONSTRUCTION

- Hand laid-up, molded fiberglass hull, deck, deckhouse and flybridge w/blend-grain balsa core in hull sides, decks and cabin top
- Solid keel, strakes and chines

MECHANICAL

- Acoustical and thermal insulation
- Air conditioning, zoned w/reverse cycle heat
- Bilge pumps (3)
- Dockside water connection w/pressure reducing valve
- Engine room blowers
- External sea strainers
- Fresh water fill hose, engines and generator
- Fuel lines, flexible aircraft type
- Fuel/water separator filters
- FWC propulsion-engines, generator
- Glendinning automatic synchronizer
- Halon fire protection system-automatic and manual
- Holding tank w/dockside & overboard pumpout
- Hot water heater
- Hour meters
- Hydraulic steering
- Intermediate struts, manganese bronze
- Mufflers-engines and generator
- Oil changing system, engines and generator
- Propellers, Nibral
- Reinforced fiberglass fuel tanks
- Rudders, manganese bronze
- Seacocks, underwater thru hulls
- Shafts 1 1/2" S.S. - double taper, Aquamet 22
- Structural steel engine beds
- Struts, manganese bronze
- Trim tabs, double piston
- Twin diesel engines w/reduction gearing
- Water lines, copper
- Water system, pressurized
- Water tanks, sanitized fiberglass, constant trim

ELECTRICAL

- Anchor light
- Batteries, heavy duty w/fiberglass box
- Battery charger
- Battery paralleling switch (diesel only)
- Bonded electrical system with ground plate
- Color coded wiring system
- Engine room lights
- Engine water temperature alarm, audible
- Generator/RI
- Generator control panel
- Instrument panel lights
- Lighting, 1 2V & 1 20V throughout
- Low oil pressure, audible
- Master control panel (AC/DC circuit breakers, voltmeters, ampmeters)
- Navigation lights
- Receptacles, 120V duplex
- Reverse polarity light
- Vaporproof battery switches.
- 30A/1 20V dockside w/one 50' cord
- 50A/240V dockside w/one 50' cord

FLYBRIDGE

- Bimini top w/full enclosure, & three horseshoe openings
- Dual lever controls
- Handrails
- Helm seat, companion seat, adjustable
- Hydraulic steering
- Instrumentation, lighted
- Lighted 5" compass
- Lockers
- Lounge seats (two) w/vinyl covered foam cushions
- Molded fiberglass
- Safety monitoring system: fire, bilge pump, high bilge water, high exhaust temperature, bilge blower, generator and synchronizer
- Storage under seat
- Windshield venturi-type w/grab rail

SALON

- Booth dinette
- Carpeting throughout
- Engine access hatch
- Entertainment system, w/color TV w/antenna, Beta Hi-Fi VCR, AM-FM stereo and cassette tape deck
- L-shaped lounge, convertible
- Lighting, 1 20V w/dimmer
- Mini blinds
- Sliding salon door
- Sliding side windows w/screens
- Storage cabinets
- Teak grab rail
- Teak interior
- Upholstered chair
- Upholstery and drapes, professionally designed

GALLEY

- Electric range, 3-burner
- Exhaust fan
- Garbage disposal
- Instant hot water
- Microwave/convection oven
- Refrigerator/freezer (19 cu. ft.)
- Single lever hot and cold faucet
- Sink, stainless steel
- Storage cabinets and drawers
- Stowage for dishes and glasses
- Teak parquet flooring
- Water filter
- Water level gauge
- Water pump light

MASTER STATEROOM

- Carpeting throughout
- Hanging lockers
- Hatch
- Indirect lighting
- Large drawers under bed
- Queen-size walk-around bed w/mattress
- Reading lights, 12V
- Storage cabinets
- Storage drawers
- Stereo speakers w/controls

MASTER HEAD

- Electric toilet
- Exhaust fan
- Mirror
- Receptacle, 120V ground fault
- Shower and tub
- Teak towel bar
- Vanity w/sink and storage
- Vinyl flooring

GUEST STATEROOM (Forward)

- Carpeting
- Hanging locker
- Queen-size walk-around bed w/mattress
- Reading lights, 12V
- Stereo speakers w/controls
- Storage drawers
- Vinyl headliner

GUEST STATEROOM (MID)

- Berth covers
- Berth lights, 12V
- Carpeting
- Hanging locker
- Stereo speakers w/controls
- Storage drawers
- Upper and lower berths
- Vinyl headliner

GUEST HEAD

- Electric toilet
- Exhaust fan
- Mirror
- Receptacle, 120V ground fault
- Stall shower
- Teak towel bar
- Vanity w/sink and storage

SAFETY & MISCELLANEOUS

- Anchor
- Anchor chocks
- Anchor rode, 200' 1/4" nylon
- Anti-fouling bottom paint
- Bow pulpit
- Bow rail
- Central vacuum
- Depthfinder
- Dual air horns
- Fire extinguishers (3)
- Foredeck seat w/cushions and cover
- Grab rails
- Halon fire protection system, automatic and manual
- Knotmeter
- SSB grid
- Stainless steel bow cleats
- Stainless steel spring cleats (4)
- Stainless steel stern cleats (2)
- Tempered glass, all windows
- VHF radio w/antenna
- Zincs on rudders

COMPANIONWAY AND AFT DECK

- Central vacuum
- Lighting, 1 2V
- Storage locker
- Washer and dryer
- Aft deck hardtop (TI)

48' Motor Yacht'AI

Twin G.M. 6V-92TIB 463,000.....Twin G.M. 8V-92TIB 501,000

OPTIONAL EQUIPMENT(A-E)

<p>Air Conditioning Aft Deck 6,625</p> <p>Canvas</p> <p>Helm chair covers (2) 180</p> <p>Salon carpet runner 180</p> <p>Salon furniture covers 640</p> <p>Decor</p> <p>Custom decor 7,700</p> <p>Decor kit, mini 3,815</p> <p>Decor kit, maxi 6,435</p> <p>Pillow shams (2) 320</p> <p>Quilted bedspread (MSR) 1,100</p> <p>Quilted bedspread (GSR) 700</p> <p>Electrical(I-F)</p> <p>1 20 volt duplex receptacle 75</p> <p>1 20 volt weatherproof receptacle 165</p> <p>1 2 volt weatherproof receptacle 125</p> <p>Electronicst(E)</p> <p>Fender Racks 670</p> <p>Flybridge, Integrated Electronics Console(^{en}) 2,460</p> <p>Glendinning Cable Master 1,400</p> <p>Hardtop, Flybridge 9,000</p> <p>Heater, Electric (Each) 235</p> <p>Heating</p> <p>Transom 270</p> <p>Bow 210</p> <p>Lights</p> <p>Docking 685</p> <p>Remote spotlight 1,680</p> <p>1 2V step (2) 130</p>	<p>Paint, Micron bottom paint 1,315</p> <p>Portlights (Each) 130</p> <p>Propellers, Spare (2) 1,670</p> <p>Perm-A-Pub (Aft Deck Bar) 575</p> <p>Seawater Washdown 910</p> <p>Shaft, Spare (1) 1,755</p> <p>Stereo Speakers, Flybridge 305</p> <p>Swim Platform 3,775</p> <p>Swim ladder 250</p> <p>Telephone/Television</p> <p>Additional outlets (Each) 115</p> <p>Television</p> <p>13" color TV built-in and additional antenna outlet in Master Stateroom or Forward Stateroom (Each) 890</p> <p>VCR, VHS in Lieu of Beta 220</p> <p>Water Delivery Kit^{***I} 425</p> <p>Water Maker</p> <p>200 gallons per day 6,800</p> <p>400 gallons per day 8,000</p> <p>Windlass</p> <p>Model BHW 2,920</p> <p>Chain for BHW (per ft.) 6</p> <p>Y-Valve Emergency Bilge Pumps (2) 820</p> <p>Cradle, Launch and Make Ready, Fuel and Freight IE)Additional</p> <p>Interior Decor Selection:</p> <p><input type="checkbox"/> Mauve & Melon <input type="checkbox"/> Creme de Menthe <input type="checkbox"/> Coral Sand</p> <p><input type="checkbox"/> Misty Blue <input type="checkbox"/> Graphics <input type="checkbox"/> Custom</p> <p>Paint Selection:</p> <p><input type="checkbox"/> Blue <input type="checkbox"/> Burgundy</p>
--	---

NOTES

- A The right is reserved to make changes, without notice, at anytime, in equipment, materials, prices and specifications. Line drawings and photos may show some optional equipment.
- B Capacities of tanks are estimates and usable volume will vary depending upon conditions.
- C These prices apply only if order is placed prior to boat going into production. Prices are for standard installation only. Custom work is extra cost.
- D Weight shown is calculated with fuel, water and holding tanks empty.
- E Prices available through dealer.
- G Includes overhead electronics console, full enclosure w/3 forward openings, and credit for standard bimini top and enclosure.
- H Includes credit for standard.
- I Speeds are at factory under new boat test conditions. Speeds and other performance characteristics are not guaranteed or warranted. Includes mooring lines (5), life jackets (6 adult), life ring (21"), flare kit, fenders; 10" (2), engine oil (5 gal.), A.T. Fluid (2 qts.) (Gas), deck mop, deck brush, bucket, hose, nozzle, fuel filters: engines and generator, raw water pump impeller for main engine (1), Boat Soap (1 qt.) and Bilge Cleaner (1 qt.).
- O Special electronics packages available for factory installation. See electronics brochure for details.
- R Generator is not intended to supply power for all standard and optional accessories. Load must be limited to generator output rating.
- T Includes hard enclosure, wing doors, telephone/television outlets, lighting and bar with ice maker.

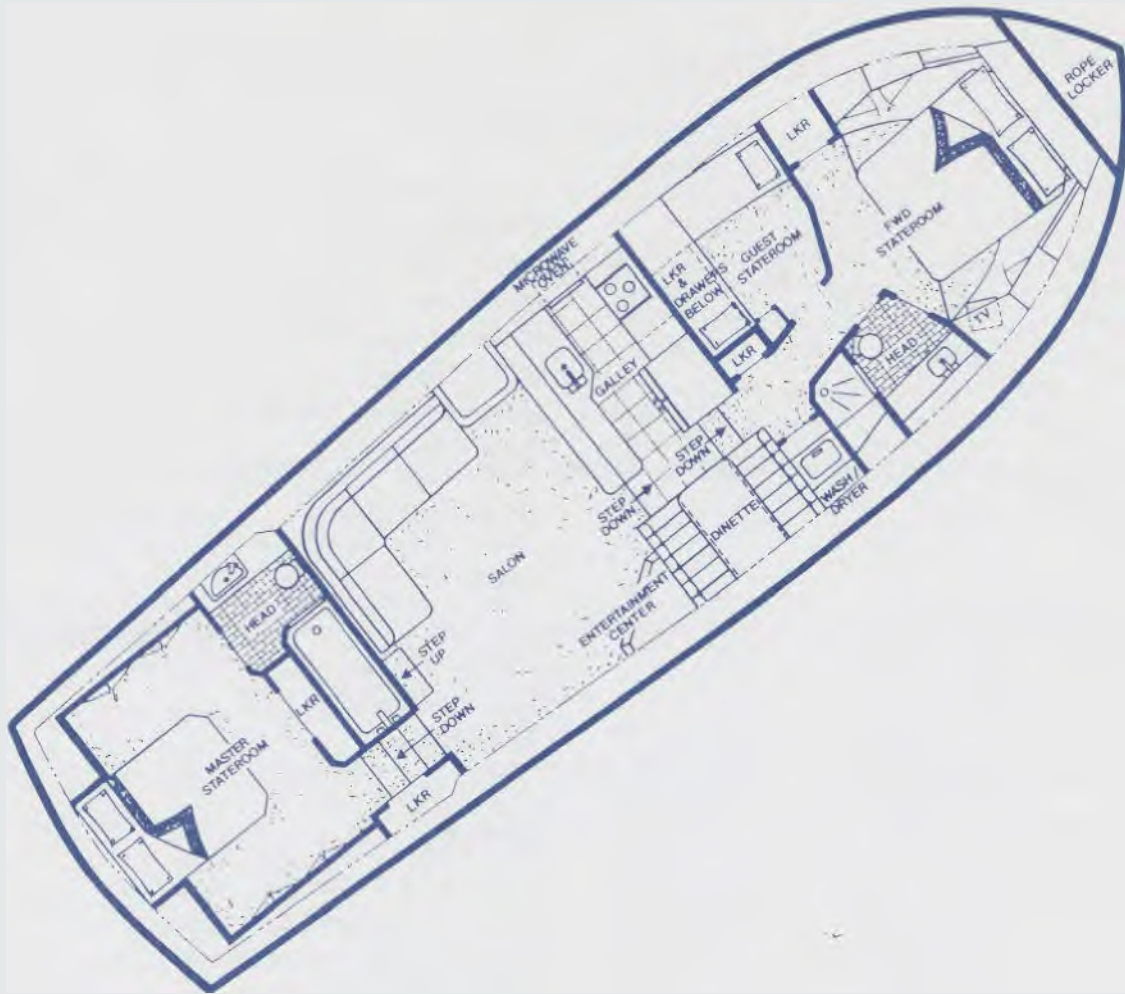

VIKING ONE YEAR LIMITED WARRANTY

1. Viking warrants to the original purchaser, for a period of One (1) year, from the date of delivery, Eighteen (18) months from the date of shipment from the factory, or upon completion of Two Hundred (200) hours of operation, whichever ever comes first, the following-

That Viking will, through the selling dealer, replace or repair, at the discretion of Viking, any part or component, manufactured by Viking which is proven to the satisfaction of Viking to be defective, and which has occurred under normal use and service within the warranty period.

This writing is meant to be a complete and exclusive statement of the terms of all Viking warranties.

2. THERE ARE NO OTHER WARRANTIES EXPRESS OR IMPLIED THAT EXTEND BEYOND THE FACE OF THIS INSTRUMENT. VIKING RESTRICTS ITS WARRANTY TO REPAIR OR REPLACEMENT IN LIEU OF ALL OTHER WARRANTIES EXPRESS OR IMPLIED. VIKING SHALL NOT BE LIABLE FOR ANY INCIDENTAL, CONSEQUENTIAL OR INDIRECT DAMAGES CAUSED AS A RESULT OF ANY DEFECT IN WORKMANSHIP, REPAIR OR REPLACEMENT. SOME STATES DO NOT ALLOW LIMITATIONS ON HOW LONG AN IMPLIED WARRANTY LASTS, SO THE ABOVE LIMITATION MAY NOT APPLY TO YOU. SOME STATES DO NOT ALLOW THE EXCLUSION OR LIMITATION OF INCIDENTAL OR CONSEQUENTIAL DAMAGES, SO THE ABOVE LIMITATION OR EXCLUSION MAY NOT APPLY TO YOU. THIS WARRANTY GIVES YOU SPECIFIC LEGAL RIGHTS, AND YOU MAY ALSO HAVE OTHER RIGHTS WHICH VARY FROM STATE TO STATE.

3. Viking invites any purchaser to inspect the vessel before purchase, with any experts [mechanical or otherwise] to determine to the purchaser's satisfaction, the condition of the vessel prior to purchase.

4. The dealer is not the agent of Viking and Viking does not authorize the dealer, or any other person, to assume for Viking any liability in connection herewith or any liability or expenses intoned in the repairing or its product other than those expressly authorized herein. After an authorized dealer has been assigned by Viking for warranty work, reimbursement for labor costs provided by the dealer under the Viking warranty will be based upon a rate and schedule established by Viking. This reimbursement shall be through the selling dealer.

5. Viking reserves the right to improve its products through change and design or material without obligation to incorporate such change in boats of prior manufacture. Viking does not have a model year: an such, and changes are incorporated in boats by the manufacturer as same are constructed from time to time. Viking does not warrant or represent that a particular boat is of a particular model year.

6. The defect must be reported to Viking in writing within Thirty (30) days of the [discovery of same with the following information:

- la) Owner's name and address;
- lb) Boat serial number (hull number);
- lc) Information as to nature of defect;
- ld) Date actually placed in service;
- lis) Accumulated hours of days of service.

All warranty notice and other necessary communications in connection with this warranty should be sent to the following address:

Viking Yacht Company
Route 9
On the Bass River
New Gretna, New Jersey 06224

7. You may inquire regarding warranty coverage, etc., by means of the following:
- (a) Contacting the Viking dealer from which you purchased your Viking for an inspection of the problem involved.
 - (b) Delivering your Viking to the selling dealer for an examination on the premises.
 - (c) Contact the company at the above-mentioned address,

8. All warranty claims for engines shall be presented directly to the engine manufacturer. Correspondence to the engine manufacturer shall include the engine serial number, date of purchase, dealer from whom purchased, accumulated hours, and description of the alleged defects. Copies of all correspondence shall be forwarded to Viking at the time of the original transmittal of same. Viking passes on any and all warranties of products or components which are not of Viking's manufacture and any warranty provided by the manufacturer is assigned to the owner, if possible.

9. Viking will not be responsible for any damage to a vessel, or parts thereof, which have been subjected to abuse or neglect, faulty installation by personnel not directly employed by Viking, lack of, or improper maintenance, or failures caused by accident.

10. This warranty shall not apply to:
- (a) Products or components not manufactured by Viking,
 - (b) Parts altered in any manner from original manufacture.
 - (c) Fuel consumption or performance characteristics because they are merely estimates.
 - (d) Varnishes, gelcoats, paints, fabrics, chromium plated and stainless steel finishes because of differing climactic conditions.
 - (e) Others than the first owner.
 - (f) Yachts in commercial use.
 - (g) Electronics or electronics installation.
 - (h) Canvas, enclosure or bimini in stalls down.

VIKING YACHT COMPANY • Route 9 ■ New Gretna, N.J. 08224 • (609) 296-6000