

viking yachts



EFFECTIVE ON DELIVERIES
AUGUST 1, 1988 THRU DECEMBER 31, 1988
PRICES SUBJECT TO CHANGE
WITHOUT NOTICE

viking 55' motor yacht specifications

55' MOTOR YACHT SPECIFICATIONS(A)

LOA	557"	16.94 meters	Height from water line to top of windshield	18'0"	5.48 meters
LOA with pulpit	59'3"	18.06 meters	Height from water line to top of radar arch	21'5"	6.53 meters
LOW water line	47'2"	14.38 meters	Degree of dead rise transom	15°	
Beam	17'4"	5.28 meters	Gross weight of boat 101	56,000 pounds ...	25,401.60 kilos
Draft	4'5"	1.34 meters	Fuel Capacity(8)	880 gallons	3,335 liters
Freeboard fwd	7'7"	2.31 meters	Water Capacity (B)	350 gallons	1,324 75 liters
Freeboard aft	6'7"	2.00 meters			

STANDARD EQUIPMENT

CONSTRUCTION

- Hand laid-up, molded unidirectional fiberglass hull, deck, deckhouse and flybridge wind-grain balsa core
- Solid keel and chines

MECHANICAL

- Acoustical and thermal insulation
- Air conditioning, w/ reverse cycle heat
- Bilge pumps (3)
- Dockside water connection w/pressure reducing valve
- Engine room blowers
- Engine room mechanical gauges
- External sea strainers
- Fresh water outlet in engine room
- Fresh water washdown on foredeck
- Fuel lines, flexible aircraft type
- Fuel priming pump for main engines
- Fuel/water separator filters
- FWC propulsion-engines, generator
- Glendinning automatic synchronizer
- Halon fire protection system-automatic/manual
- Holding tank w/overboard y-valves
- Hot water heater
- Hour meters
- Hydraulic steering and engine controls
- Main and intermediate struts
- Manifold fuel filters for main engines
- Mufflers-engines and generator
- Oil changing system, engines, transmissions and generator
- Propellers, bronze
- Reinforced fiberglass fuel tank
- Seacocks, underwater thru hulls
- Shafts (2) 2 1/2" S.S. - double taper
- Trim tabs, double piston
- Twin diesel engines w/reduction gearing
- Water system, pressurized
- Water tank, fiberglass

ELECTRICAL

- Anchor light
- Batteries, heavy duty
- Battery chargers 12 and 24 volt
- Bonded electrical system with ground plate
- Color coded wiring system
- Dual 50A/240V dockside (P&S) with two 50' cords
- Engine room lights
- Engine water temperature alarms, audible
- Generator(R) 20 KW
- Generator control panel
- Instrument panel lights
- Lighting, 12V & 120V throughout
- Low engine oil pressure, audible
- Master control panel (AC/DC circuit breakers, voltmeters, ammeters)
- Navigation lights
- Receptacles, 120V duplex
- Vaporproof battery switches

FLYBRIDGE

- Bimini top
- Dual lever (Hydraulic) controls
- Handrails
- Helm seat, companion seat, adjustable
- Hydraulic steering
- Instrumentation, lighted
- Lighted 5" compass

- Lockers
- Lounge seating, U-Shaped with table
- Molded fiberglass
- Monitoring systems: fire, bilge pump, high bilge water, high exhaust temperature, and generator
- Storage under seating
- Windshield, venturi-type w/grab rail

DINING SALON

- Access to master stateroom and utility room
- Accommodates formal dining furniture
- Fully opens to salon
- Lighting, 120V/112V
- Sliding side windows
- Storage cabinets
- Teak grab rail
- Teak interior
- Wet bar with Ice maker

MAIN SALON

- Lighting, 12V
- Sliding windows
- Teak interior
- Telephone outlet
- Television, VCR, AM/FM stereo with cassette and CD player

GALLEY

- Dishwasher
- Electric range, 4 burner
- Exhaust hood
- Garbage disposal
- Microwave/convection oven
- Pantry adjacent to refrigerator/freezer
- Refrigerator/freezer
- Salon level with open access to pilothouse and dining area
- Single lever hot and cold faucet
- Sink, stainless steel, triple bin
- Storage cabinets and drawers, Conan trimmed
- Storage for dishes and glasses
- Water filter

MASTER STATEROOM

- Bronze bevelled mirror over master berth
- Bureaus with overhead storage cabinets
- Hanging lockers, cedar lined
- Hatch to aft deck
- Indirect lighting
- King-size walk-around bed w/mattress
- Reading lights, 12V
- Storage cabinets
- Storage drawers
- Stereo system with AM/FM and CD player, television with remote control

MASTER HEAD

- Exhaust fan
- Full size bathtub with shower
- Marine toilet
- Mirror
- Receptacle, 120V ground fault
- Towel bar
- Vanity with sink and storage

GUEST STATEROOM (Forward)

- Full double centerline bed with mattress
- Hanging locker

- Reading lights, 12V
- Stereo speakers w/control
- Storage drawers
- Vinyl headliner

GUEST HEAD (Forward)

- Exhaust fan
- Marine toilet
- Mirror
- Receptacle, 120V ground fault
- Stall shower
- Towel bar
- Vanity with sink and storage

GUEST STATEROOM (Port)

- Berth lights, 12V
- Full double berth
- Hanging locker
- Mirror
- Stereo speakers w/control
- Storage drawers
- Vinyl headliner

GUEST STATEROOM (Starboard)

- Berth lights, 12V
- Berths, upper and lower
- Hanging locker
- Mirror
- Stereo speakers w/control
- Storage drawers
- Vinyl headliner

GUEST HEAD (Mid)

- Exhaust fan
- Marine toilet
- Mirror
- Receptacle, 120V ground fault
- Stall shower
- Towel bar
- Vanity with sink and storage

MISCELLANEOUS

- Anchor
- Anchor rode, and chain
- Anti-fouling bottom paint
- Bow pulpit
- Bow rail
- Central vacuum
- Depthfinder
- Dual electric horns
- Fire extinguishers (3)
- Grab rails
- Halon fire protection system, automatic/manual
- Knotmeter
- Laminated safety glass, pilothouse windshield
- SSB grid
- Stainless steel bow cleats
- Stainless steel spring cleats
- Stainless steel stern cleats
- Swim platform with swim ladder
- Tempered glass, side and aft windows
- VHF radio w/antenna
- Zincs

UTILITY ROOM

- Access to engine room
- Shelf and storage cabinet
- Vinyl flooring
- Washer and dryer

55' MOTOR YACHT(A)

Twin G.M. 8V-92TA 749,000

OPTIONAL EQUIPMENTmcm

CANVAS		HEAD - MASTER STATEROOM	
Command bridge seating group covers	410	Jacuzzi-type circulation pump in master bathtub	2,945
Foredeck seat cover	230	GLASS, TINTED (side and aft windows)	1,265
Helm chair covers (each)	90	LETTERING	
Pilothouse Windshield Cover	250	Bow	320
COMMAND BRIDGE		Transom	320
Bar with refrigerator/icemaker	2,460	LIGHTS	
Bimini top enclosure	4,200	Docking	685
Additional helmseat	740	Pilothouse step lights (2)	130
CONSOLE COVER	175	Spotlight, halogen with dual remote control	2,200
DECK		OPTIONAL DECK PLAN (See drawing)	17,000
Boston Whaler 11' with 20 HP electric start outboard, and chocks	9,800	PROPELLERS, SPARE (2)	2,890
Boston Whaler 13' with 40 HP electric start outboard, and chocks	11,900	PERM-A-PUB (main salon, bar)	575
Davit, electric low profile with remote control	8,800	SHAFT, SPARE (1)	4 255
Fender tracks, sliding port & starboard	985	TELEVISION/TELEPHONE	
Fresh water H&C shower	550	Additional outlets (each)	115
Ladder, boarding with mounts port & starboard	1,425	WASHDOWN (Seawater)	910
Radar arch, welded aluminum	9,900	WATER DELIVERY KIT(N)	595
DECOR(s)		Water delivery kit with 76 piece tool set	740
(Decorating allowance \$15,000)		WATER MAKER	
DINING AREA		600 gallons per day	8,000
Overhead cabinet-above main salon wet bar	770	WINDLASS	
ELECTRICAL		Chain for BHW (per ft.)	6
120 volt duplex receptacle	125	Model BHW	2,920
120 volt weatherproof receptacle	165	Y-VALVE EMERGENCY BILGE PUMPS (2)	820
12 volt weatherproof receptacle	125	LAUNCH AND MAKE READY,	
Glendinning cablemaster, dual, 220 volt 50 amp	4,300	FUEL & FREIGHT^(E)	Additional
FORWARD OPTIONAL LAYOUT (See drawing)	8,000		
GALLEY			
Trash compactor	1 090		

- NOTES:
- A The right is reserved to make changes, without notice at anytime, in equipment, materials, prices and specifications. Line drawings and photos may show some optional equipment.
- B Capacities of tanks are estimates and usable volume will vary depending upon conditions.
- C These prices apply only if order is placed prior to boat going into production. Prices are for standard installation only. Custom work is extra cost.
- D Weight shown is calculated with fuel, water and holding tanks empty.
- E Prices available through dealer.
- N Mooring lines (6), Life jackets (6), Life ring (21"), Flare kit, Fenders: 10" (4), Engine oil (5 gal.), Deck mop, Deck brush, Bucket, Hose. Nozzle, Fuel filters: Engine and generator, Oil filters: engine and generator, Gear box filter, Raw water pump impeller for main engine (1), Boat soap (1 quart) and Bilge cleaner (1 quart).
- R Generator is not intended to supply power for all standard and optional accessories. Load must be limited to generator output rating.
- S In order to offer the full range of decor and paint: selections are required with initial order.

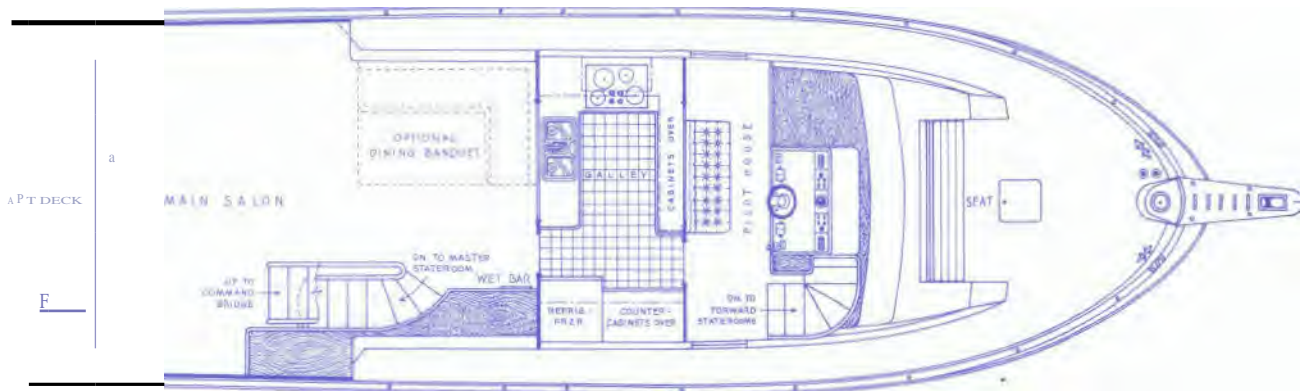

UPPER LEVEL

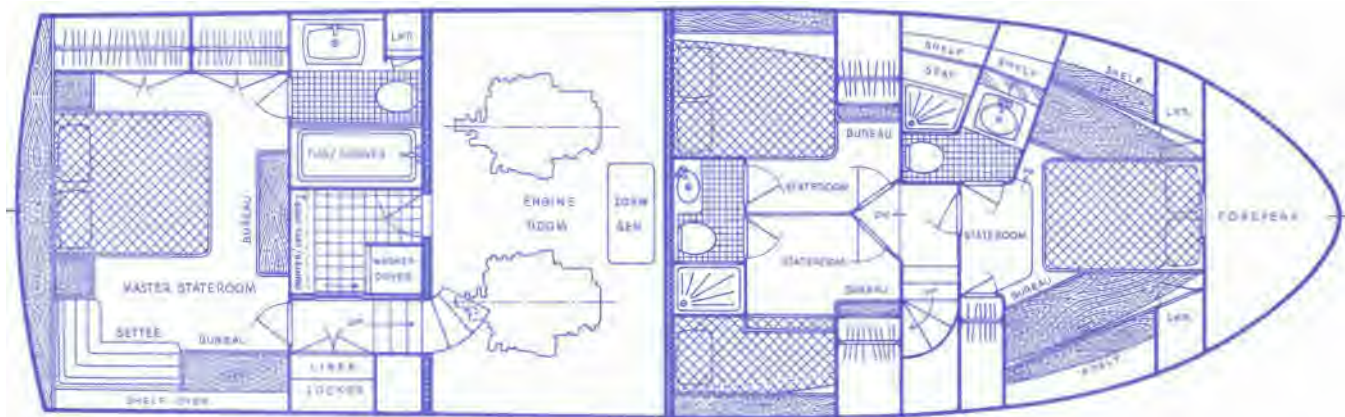

LOWER LEVEL

VIKING ONE YEAR LIMITED WARRANTY

1. Viking warrants to the original purchaser, for a period of One (1) year, from the date of delivery, Eighteen (18) months from the date of shipment from the factory, or upon completion of Two Hundred (200) hours of operation, whichever ever comes first, the following:

That Viking will, through the selling dealer, replace or repair, at the discretion of Viking, any part or component, manufactured by Viking which is proven to the satisfaction of Viking to be defective, and which has occurred under normal use and service within the warranty period.

This writing is meant to be a complete and exclusive statement of the terms of all Viking warranties.

2. THERE ARE NO OTHER WARRANTIES EXPRESS OR IMPLIED THAT EXTEND BEYOND THE FACE OF THIS INSTRUMENT. VIKING RESTRICTS ITS WARRANTY TO REPAIR OR REPLACEMENT IN LIEU OF ALL OTHER WARRANTIES EXPRESS OR IMPLIED. VIKING SHALL NOT BE LIABLE FOR ANY INCIDENTAL, CONSEQUENTIAL OR INDIRECT DAMAGES CAUSED AS A RESULT OF ANY DEFECT IN WORKMANSHIP, REPAIR OR REPLACEMENT. SOME STATES DO NOT ALLOW LIMITATIONS ON HOW LONG AN IMPLIED WARRANTY LASTS. SO THE ABOVE LIMITATION MAY NOT APPLY TO YOU. SOME STATES DO NOT ALLOW THE EXCLUSION OR LIMITATION OF INCIDENTAL OR CONSEQUENTIAL DAMAGES, SO THE ABOVE LIMITATION OF INCIDENTAL OR CONSEQUENTIAL DAMAGES, SO THE ABOVE LIMITATION OR EXCLUSION MAY NOT APPLY TO YOU. THIS WARRANTY GIVES YOU SPECIFIC LEGAL RIGHTS, AND YOU MAY ALSO HAVE OTHER RIGHTS WHICH VARY FROM STATE TO STATE.

3. Viking invites any purchaser to inspect the vessel before purchase, with any experts (mechanical or otherwise) to determine to the purchaser's satisfaction, the condition of the vessel prior to purchase.

4. The dealer is not the agent of Viking and Viking does not authorize the dealer, or any other person, to assume for Viking any liability in connection herewith or any liability or expenses incurred in the repairing of its product other than those expressly authorized herein. After an authorized dealer has been assigned by Viking for warranty work, reimbursement for labor costs provided by the dealer under the Viking warranty will be based upon a rate and schedule established by Viking. This reimbursement shall be through the selling dealer.

5. Viking reserves the right to improve its products through change and design or material without obligation to incorporate such change in boats of prior manufacture. Viking does not have a model year as such, and changes are incorporated in boats by the manufacturer as same are constructed from time to time. Viking does not warrant or represent that a particular boat is of a particular model year.

6. The defect must be reported to Viking in writing within Thirty (30) days of the discovery of same with the following information:

(a) Owner's name and address:

- (b) Boat serial number (hull number);
- (c) Information as to nature of defect;
- (d) Date actually placed in service;
- (e) Accumulated hours of days of service.

All warranty notice and other necessary communications in connection with this warranty should be sent to the following address:

Viking Yacht Company
Route 9
On the Bass River
New Gretna, New Jersey 08224

- 7. You may inquire regarding warranty coverage, etc., by means of the following:
 - (a) Contacting the Viking dealer from which you purchased your Viking for an inspection of the problem involved.
 - (b) Delivering your Viking to the selling dealer for an examination on the premises.
 - (c) Contact the company at the above mentioned address.
- 8. All warranty claims for engines shall be presented directly to the engine manufacturer. Correspondence to the engine manufacturer shall include the engine serial number, date of purchase, dealer from whom purchased, accumulated hours, and description of the alleged defects. Copies of all correspondence shall be forwarded to Viking at the same time of the original transmittal of same. Viking passes on any and all warranties of products or components which are not of Viking's manufacture and any warranty provided by the manufacturer is assigned to the owner. If possible.
- 9. Viking will not be responsible for any damage to a vessel, or parts thereof, which have been subjected to abuse or neglect, faulty installation by personnel not directly employed by Viking, lack of, or improper maintenance, or failures caused by accident.
- 10. This warranty shall not apply to:
 - (a) Products or components not manufactured by Viking.
 - (b) Parts altered in any manner from original manufacture.
 - (c) Fuel consumption or performance characteristics because they are merely estimates.
 - (d) Varnishes, gelcoats, paints, fabrics, chromium plated and stainless steel finishes because of differing climatic conditions. Others than the first owner. Yachts in commercial use.
 - (e) Electronics or electronics installation.
 - (f) Canvas, enclosure or bimini installations.
 - (g) The cost of removal or reinstallation of parts or components.
 - (h) Yachts sold and registered outside the legal Jurisdiction of the United States.